

SCHUKO® socket, 16 A 250 V ~, with LED floor pilot light, Safety Plus, thermoplastic, LS range, light grey



Reference number:	LS 1520-O LG LNW
EAN/GTIN:	4011377154810
Color:	light grey
Material:	thermoplastic (breakproof)

■ Individual colour printing possible

SCHUKO® socket with LED floor pilot light, LS1520-OLGLNW

with LED floor pilot light

with integrated brightness sensor

with enhanced contact protection / shutter (Safety Plus)

with screwless terminals for rigid wires up to 2.5 mm²

installation into deep flush box

with white LEDs (colour temperature 3500 K)

power consumption stand-by / ON: 0.3 / 0.5 W

Supporting frame, claws and claw screws are integrated into the earth protection.

Dimensions

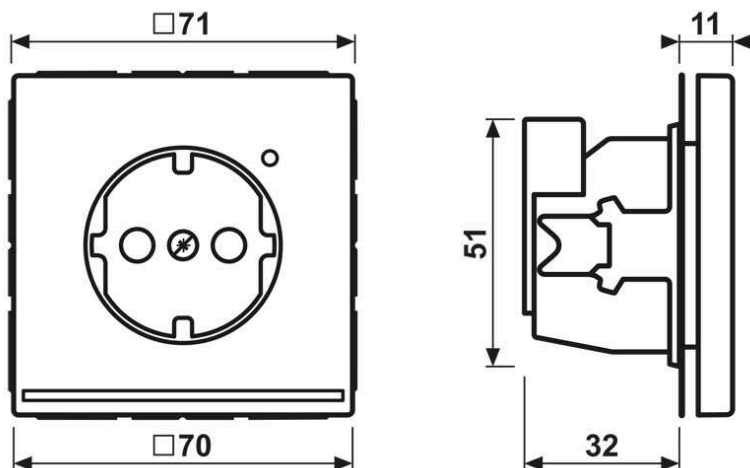

Assembly

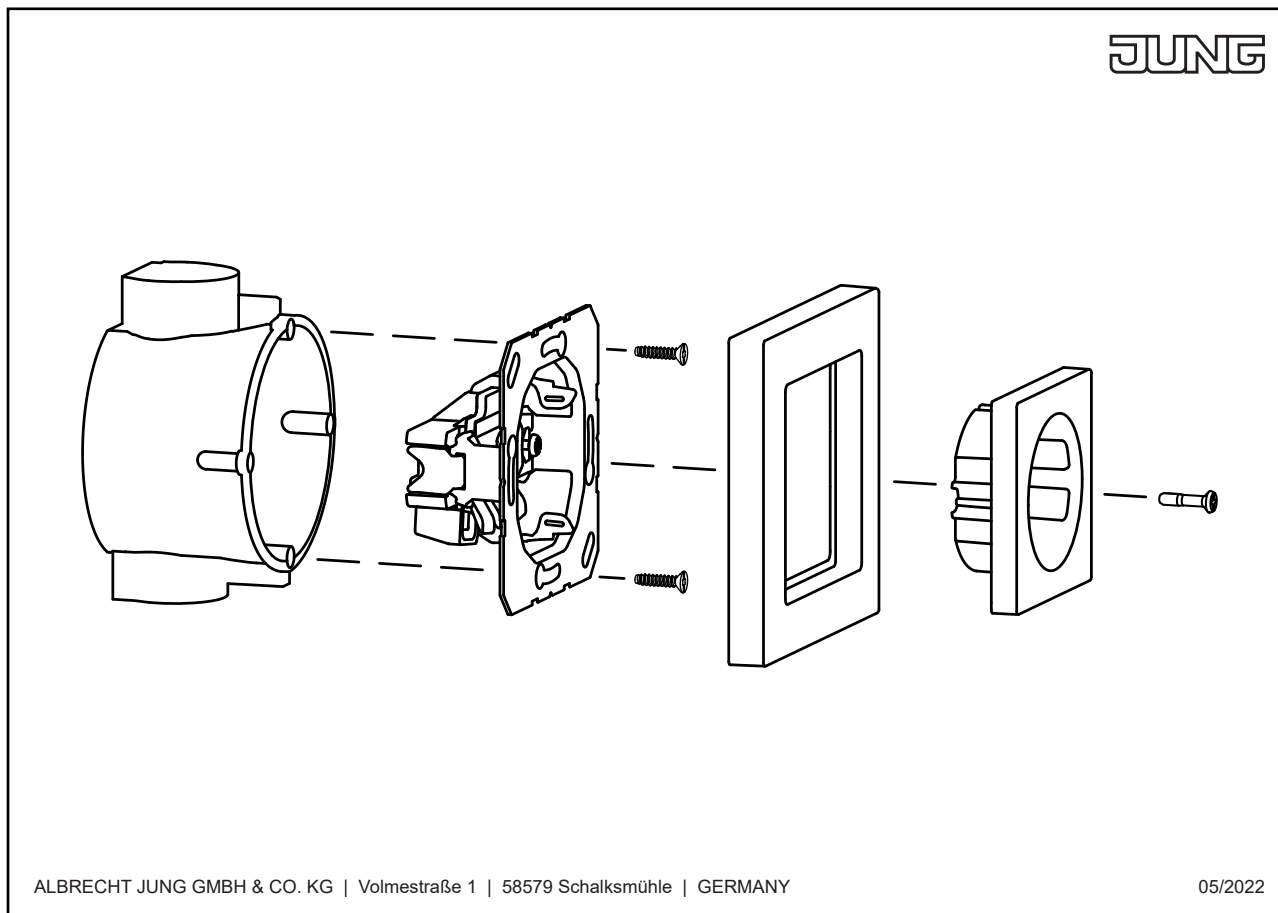

ALBRECHT JUNG GMBH & CO. KG | Volmestraße 1 | 58579 Schalksmühle | GERMANY

05/2022

Notice!**Installation only by persons with relevant electrical knowledge and experience!*)****Use only with original JUNG product components approved for this article.**

By inappropriate installation you endanger

- your own life,
- the life of the user of the electrical appliance.

By inappropriate installation you risk a high loss by damage, e.g. risk by fire.

You assume personal liability in case of injury to persons or damage of appliances.

Please contact a skilled electrician!***) Required technical knowledge for installation:**

For installation, especially the following technical knowledge is required:

- the 5 important safety rules: disconnect from mains, secure against reconnecting, verify parts are free of voltage, ground and short-circuit, cover or block off adjacent live parts
- select adequate tools, measuring devices and personal protective equipment
- evaluate measuring results
- selection of the electrical installation material to secure switch-off conditions
- IP protection levels
- installation of the electrical installation material
- type of electric power grid (TN system, IT system, TT system) and the resultant connection terms (common grounding, protective ground, required additional action etc.)