

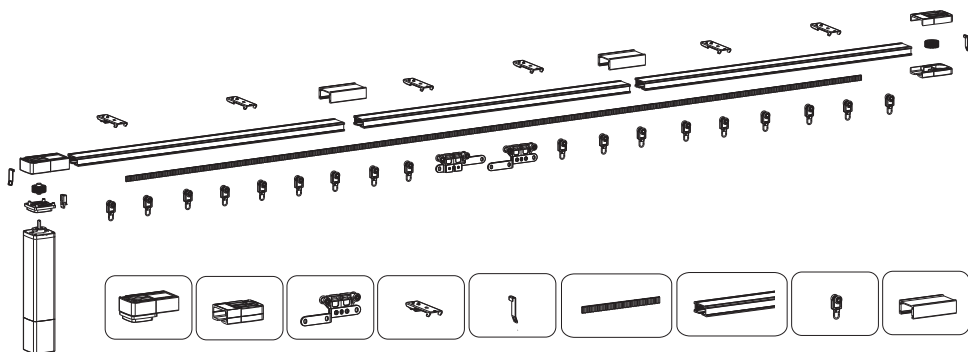

10

1.5	100 - 240 (AC)	IP40	40



		( )	( )	( )					
				( )			( )		
				1000	100	500	200	100	
1	2.2	1	1	1	2	1	1	1	<2.2
2	3.2	2	2	1	2	1	1	1	2.2 -3.2
3	4.2	3	3	1	2	1	1	1	3.2 -4.2
4	5.2	4	4	1	2	1	1	1	4.2 -5.2
5	6.2	5	5	1	2	1	1	1	5.2 -6.2
6	7.2	6	6	1	2	1	1	1	6.2 -7.2
7	8.2	7	7	1	2	1	1	1	7.2 -8.2

1.

2.

3.
- 500

,200

,100
- :

:

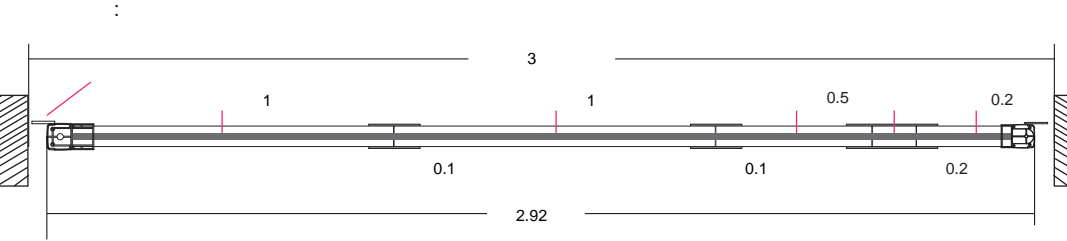
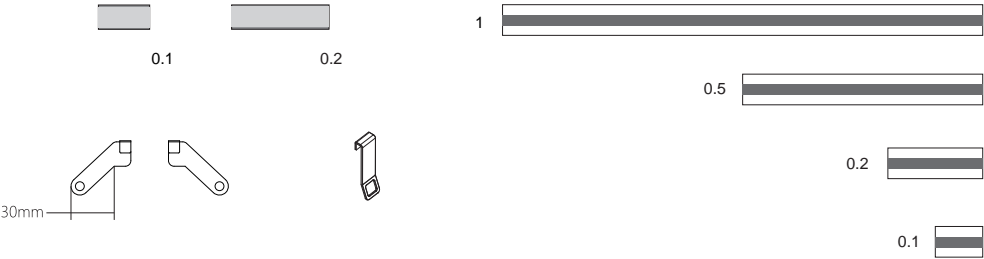



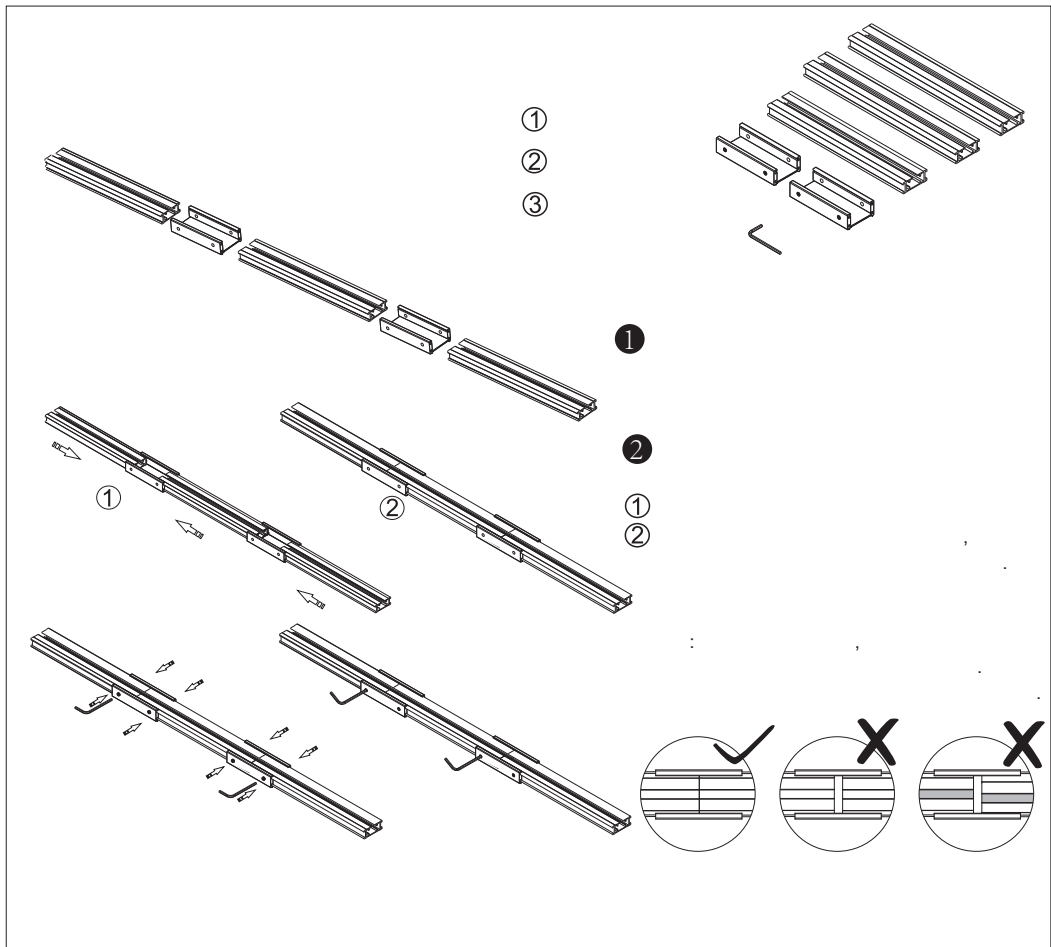
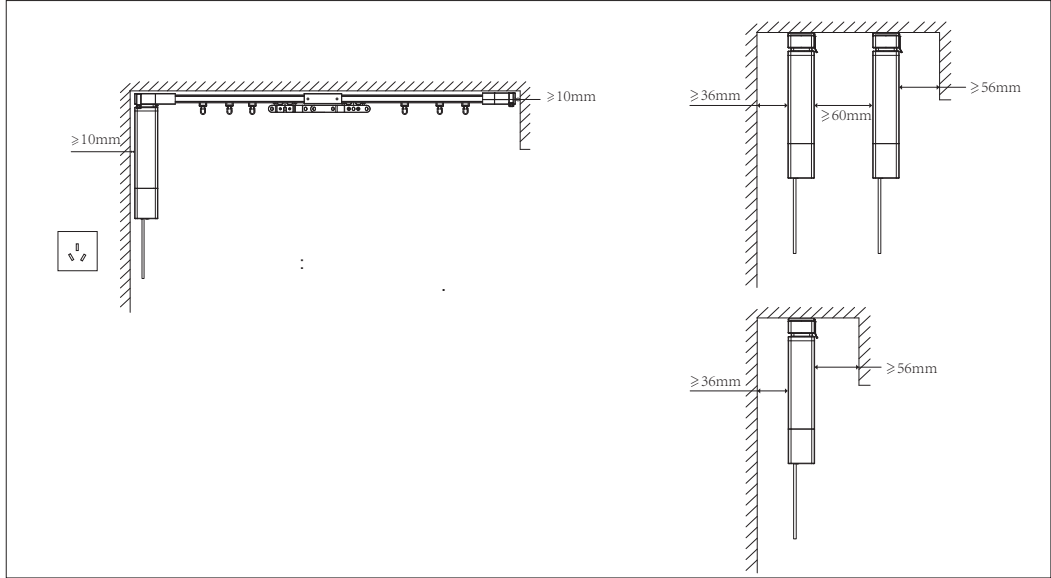

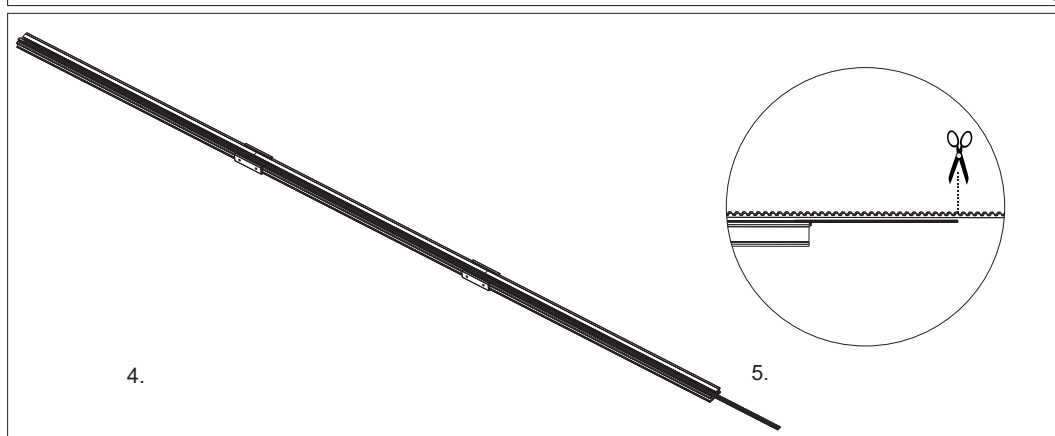
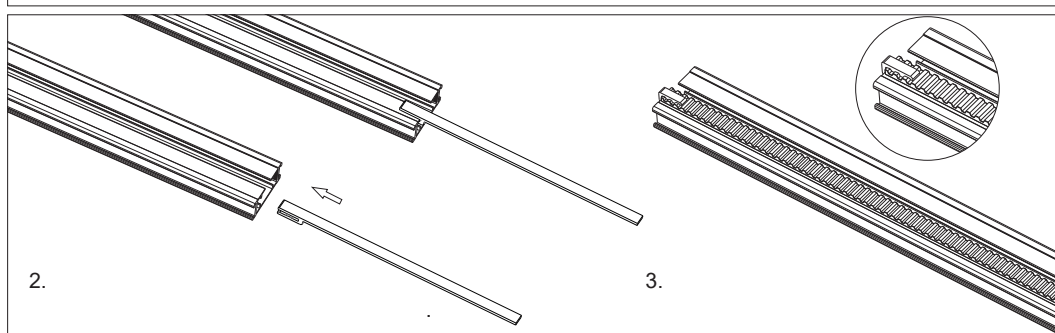
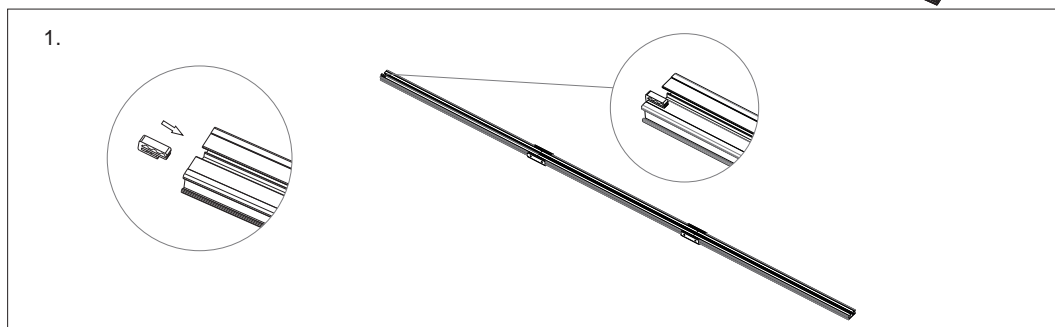
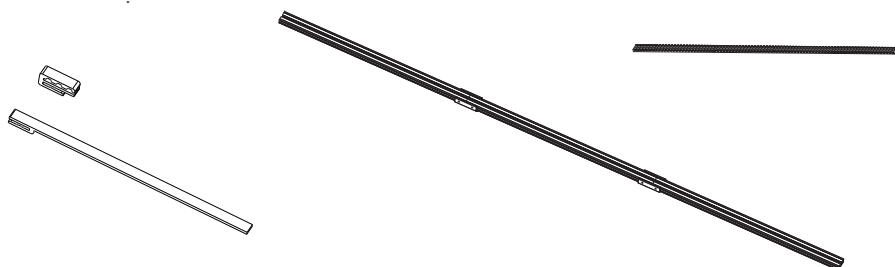

\* = + 11

\* 2

\* : 8

\* : 2

\* : 2

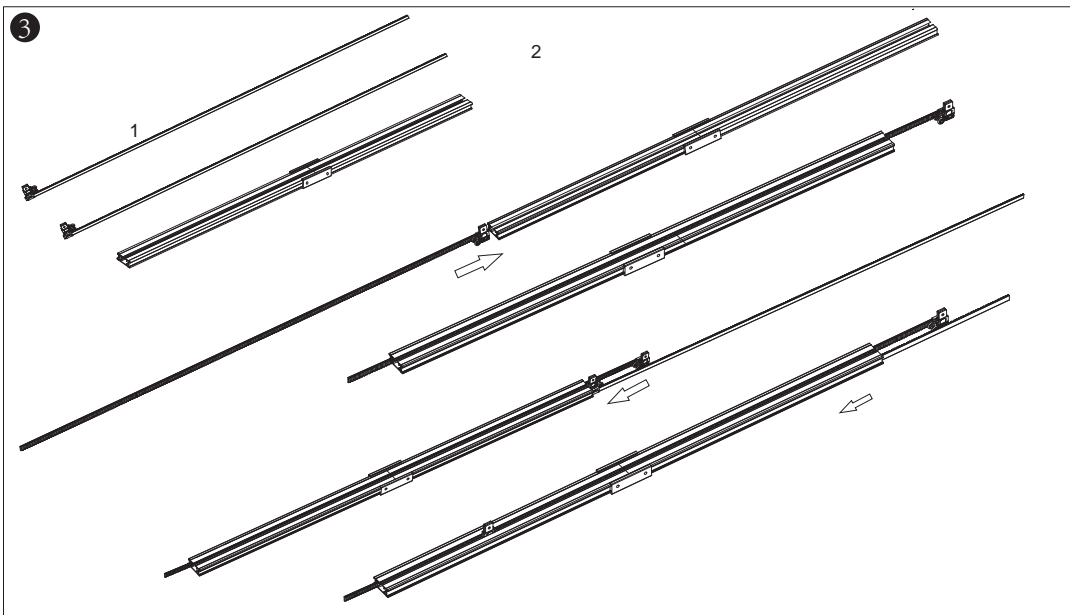
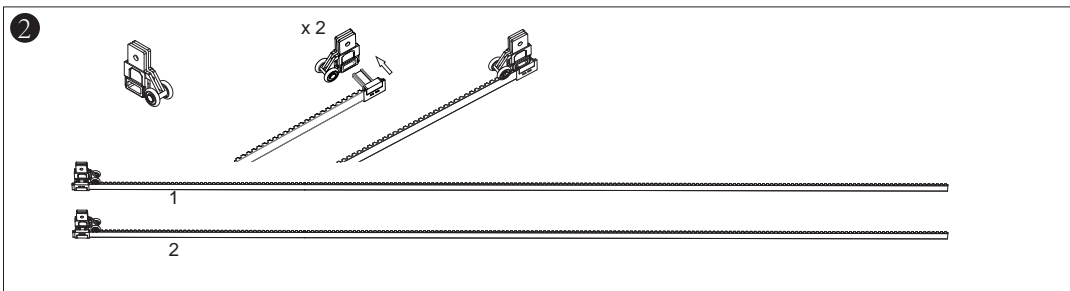
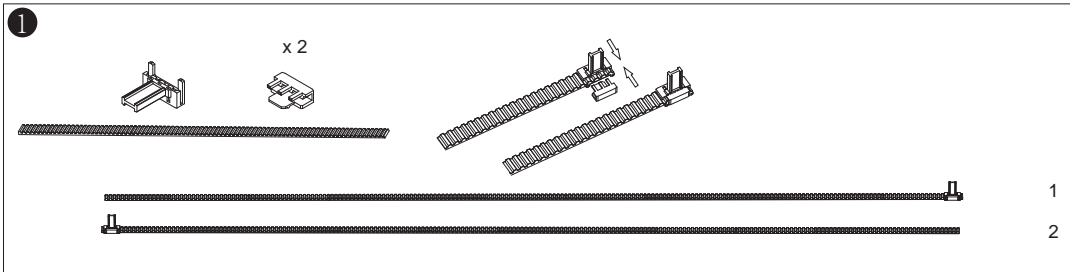
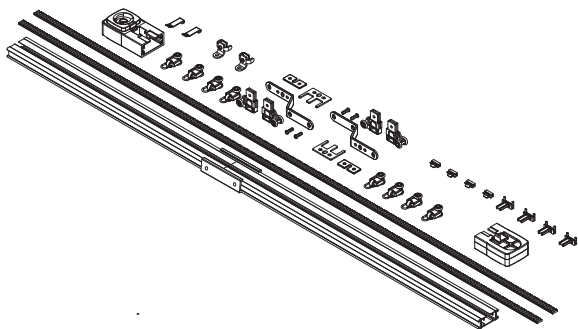

4

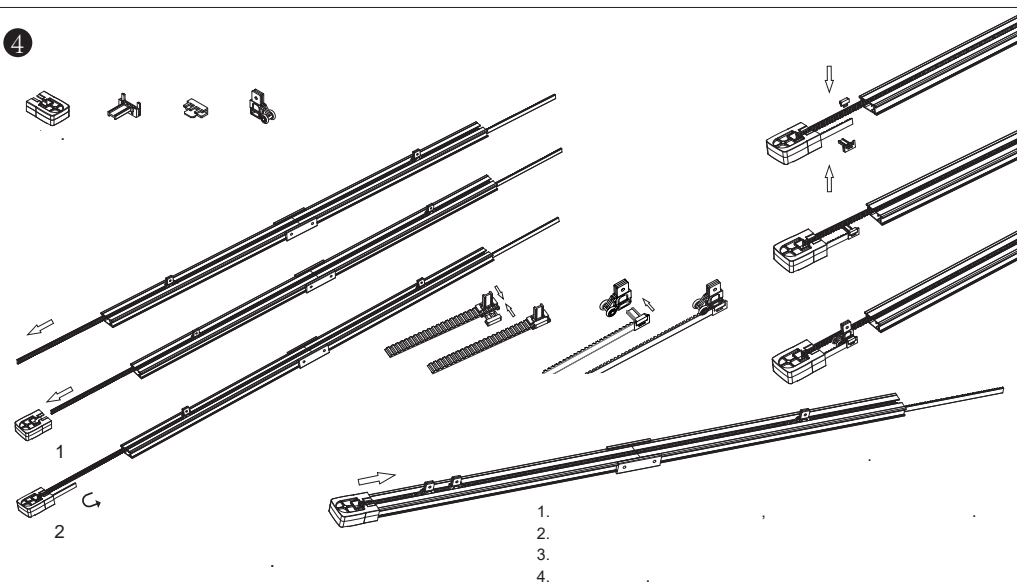

5

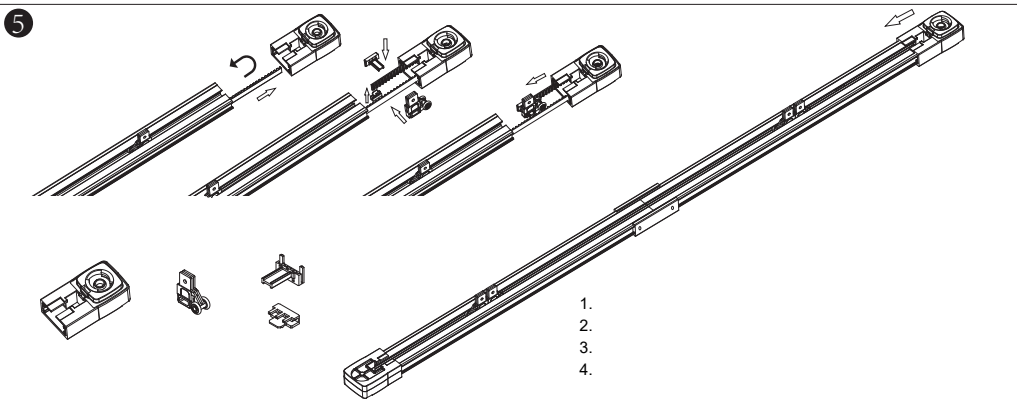

6

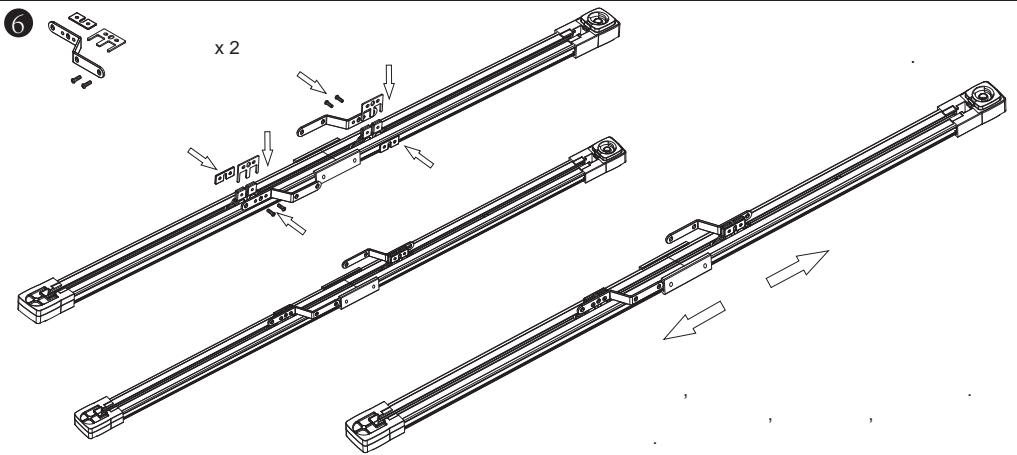

7

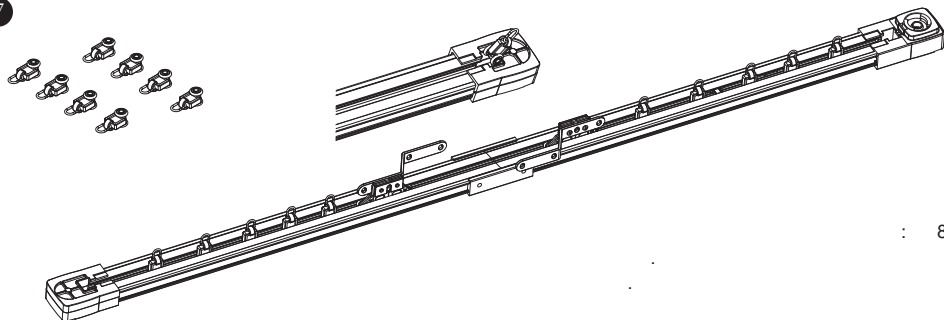

: 8

8

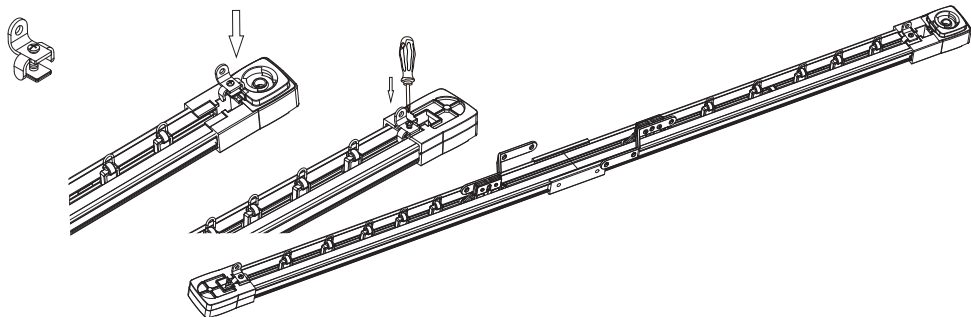

9

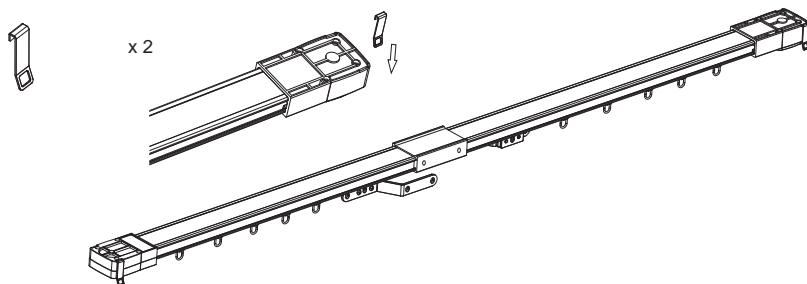

10

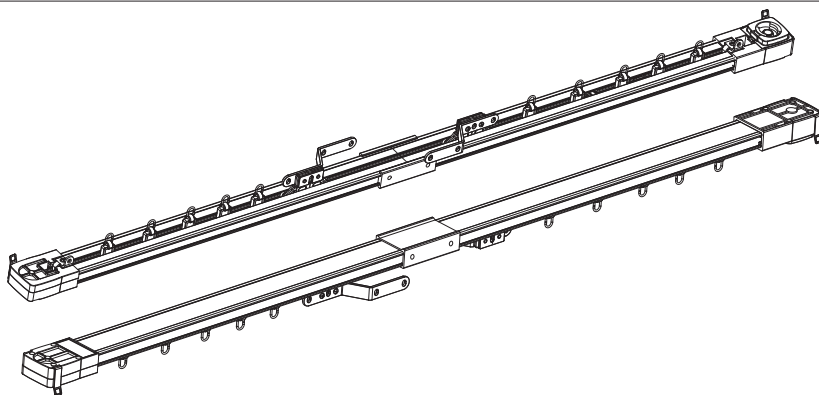

\*

\* :8

\* :1

\* :1

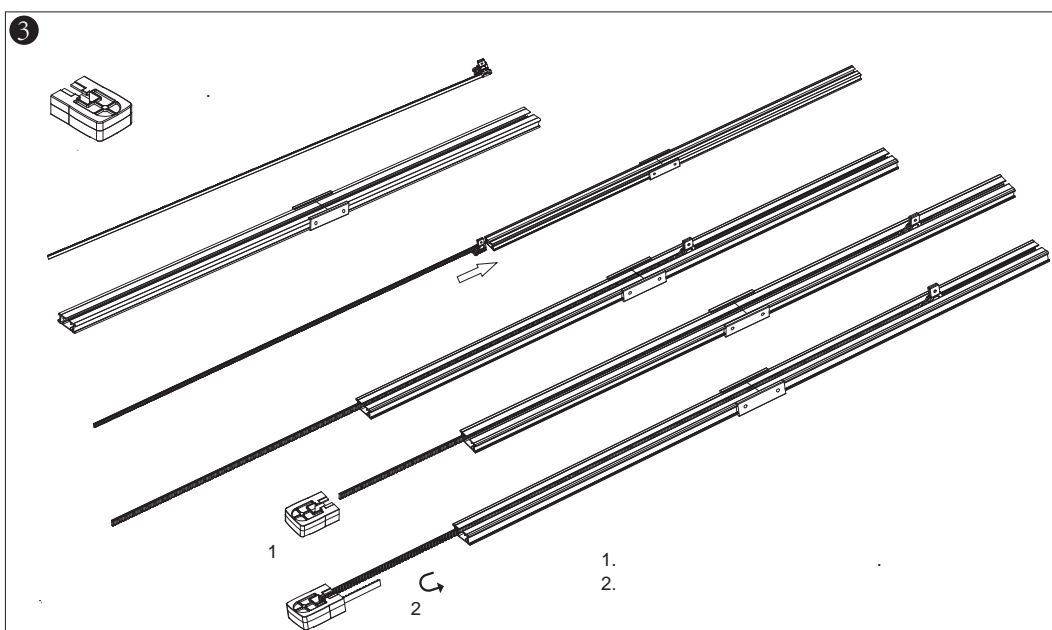
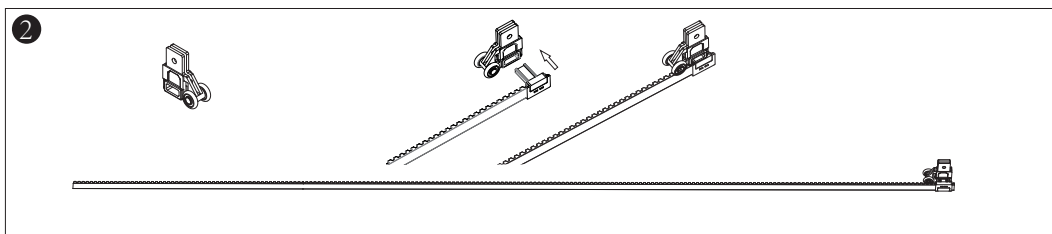
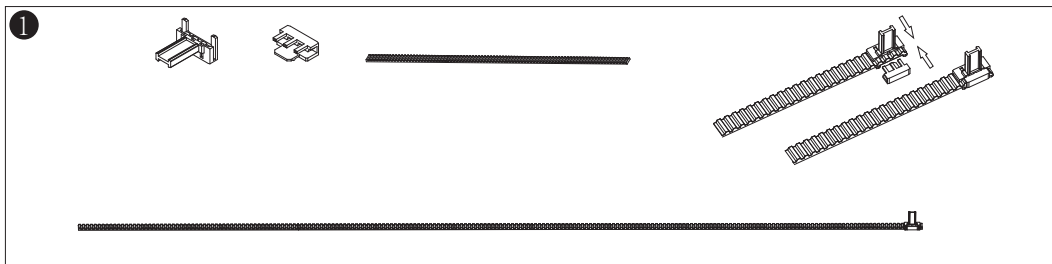

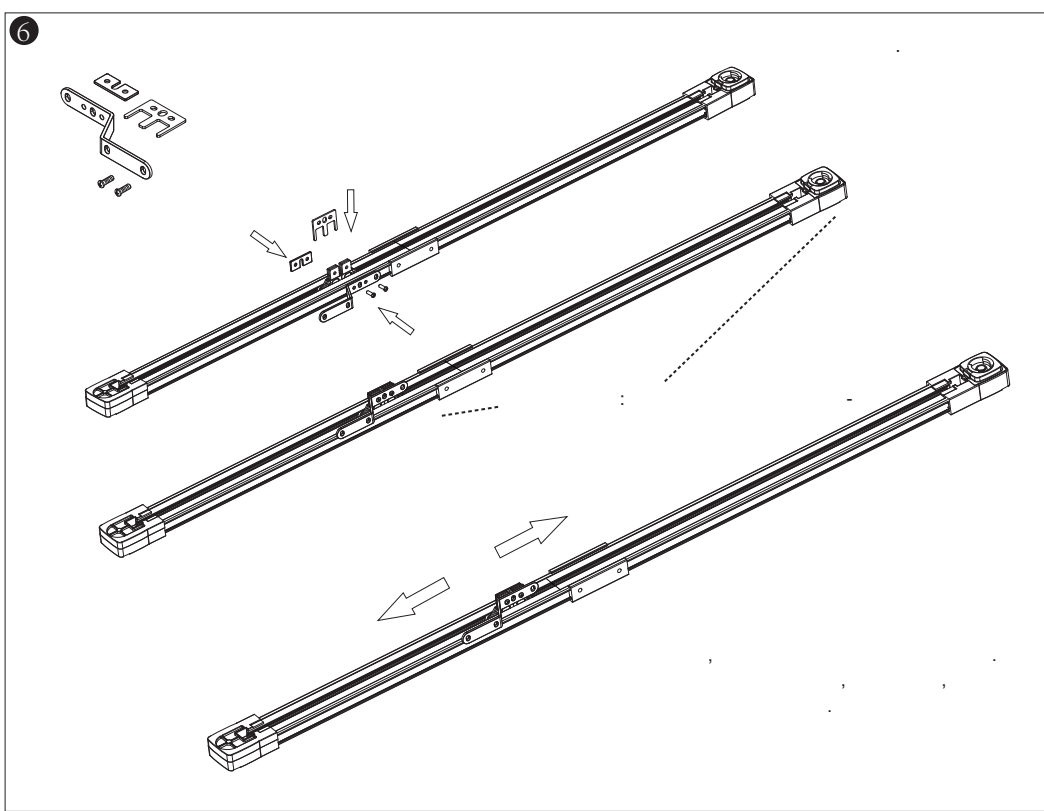
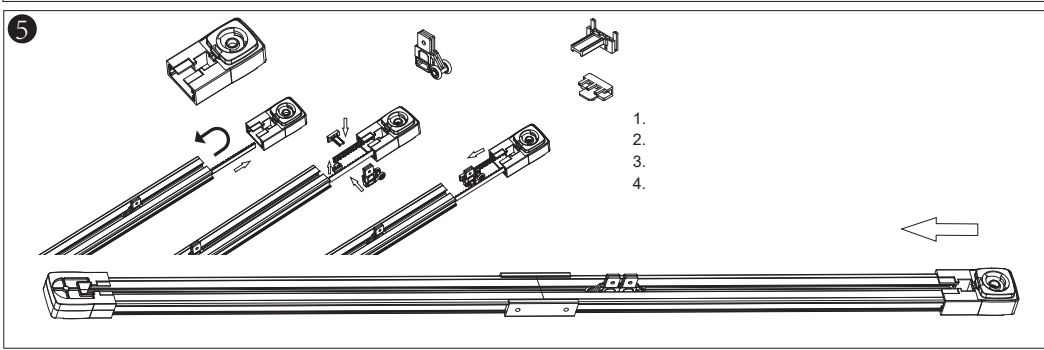
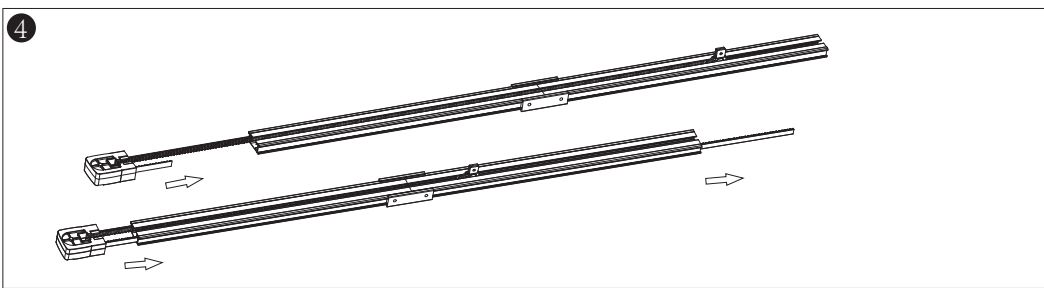

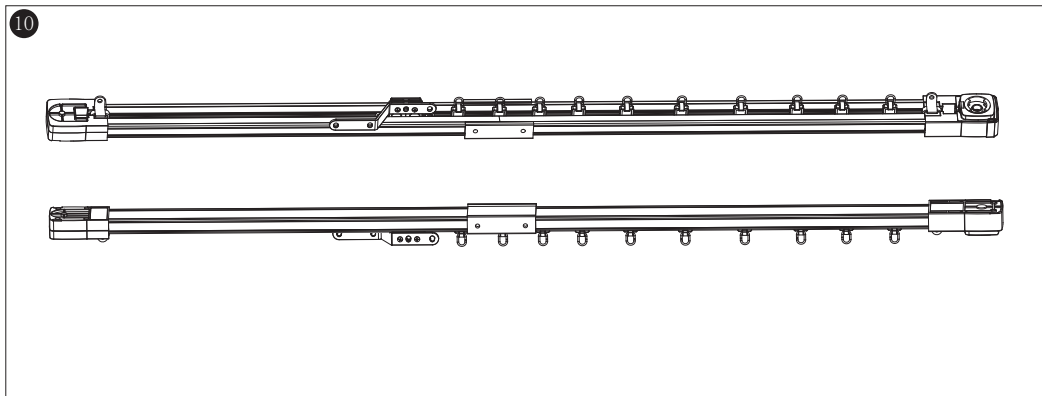
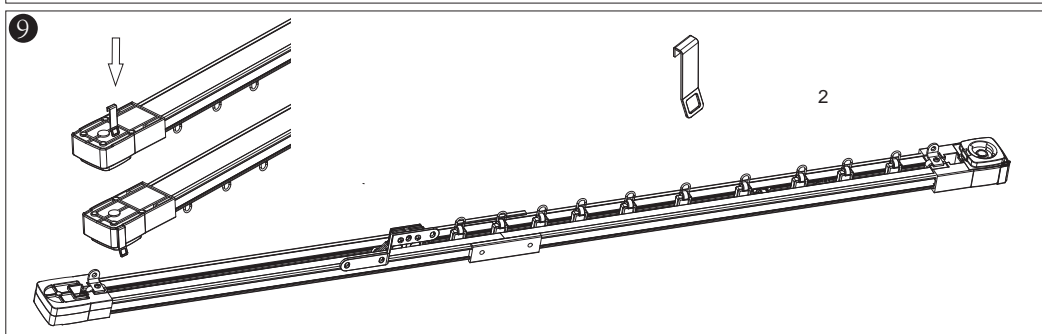
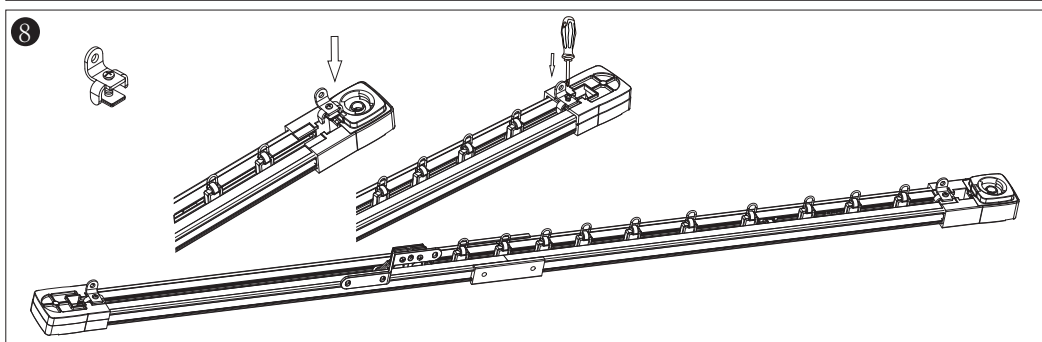
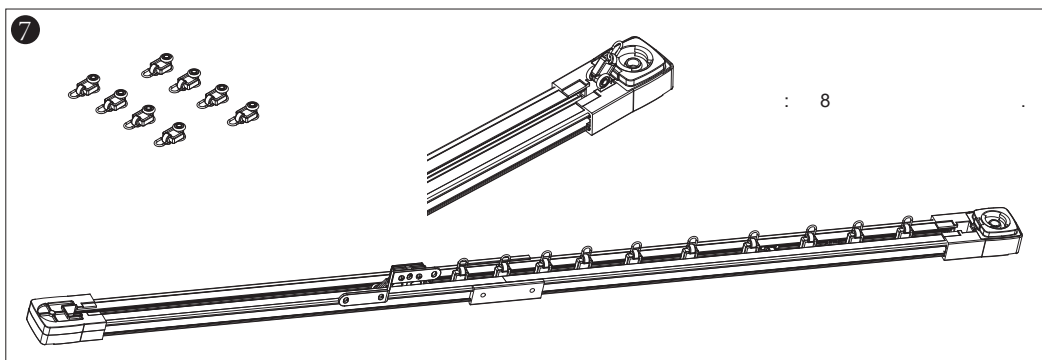



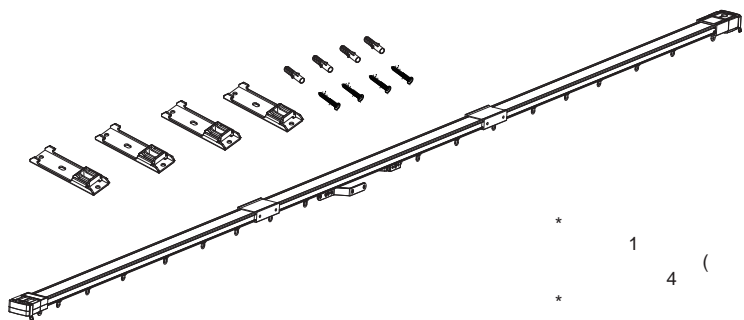

\* 1  
4 ( ) 3  
\*  
\* 2

1

Materials

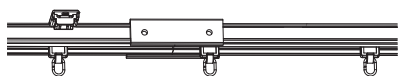
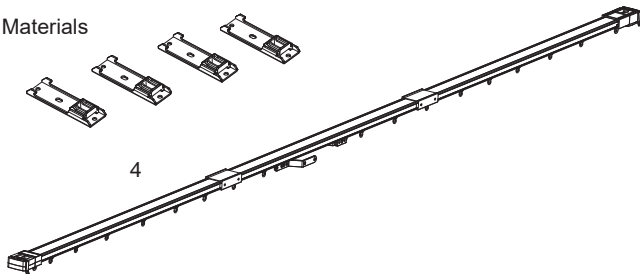

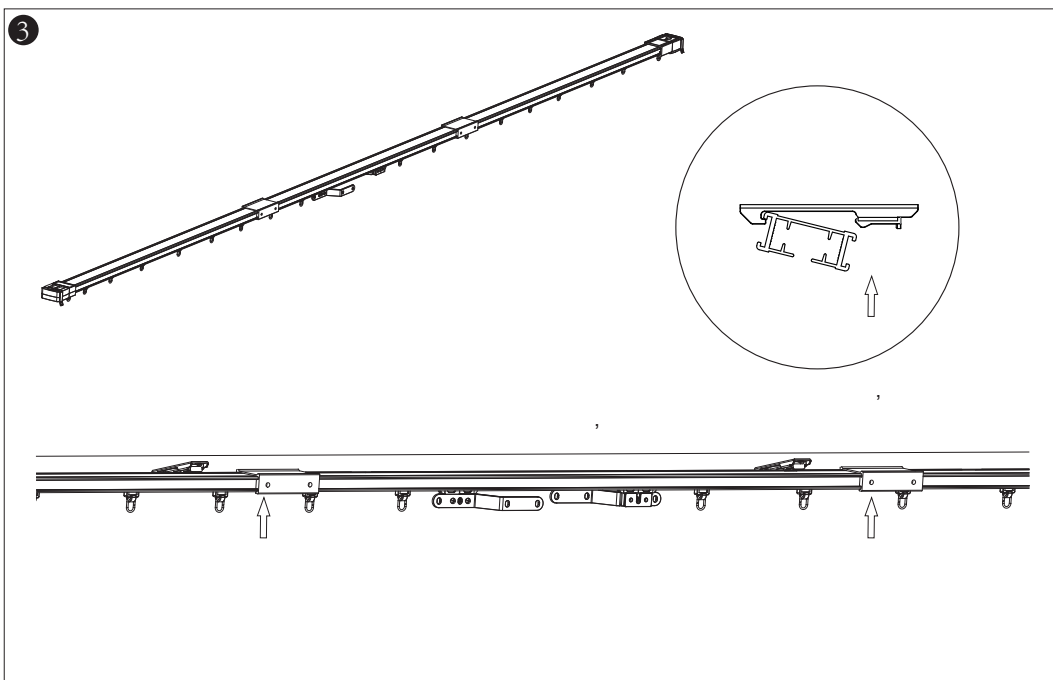
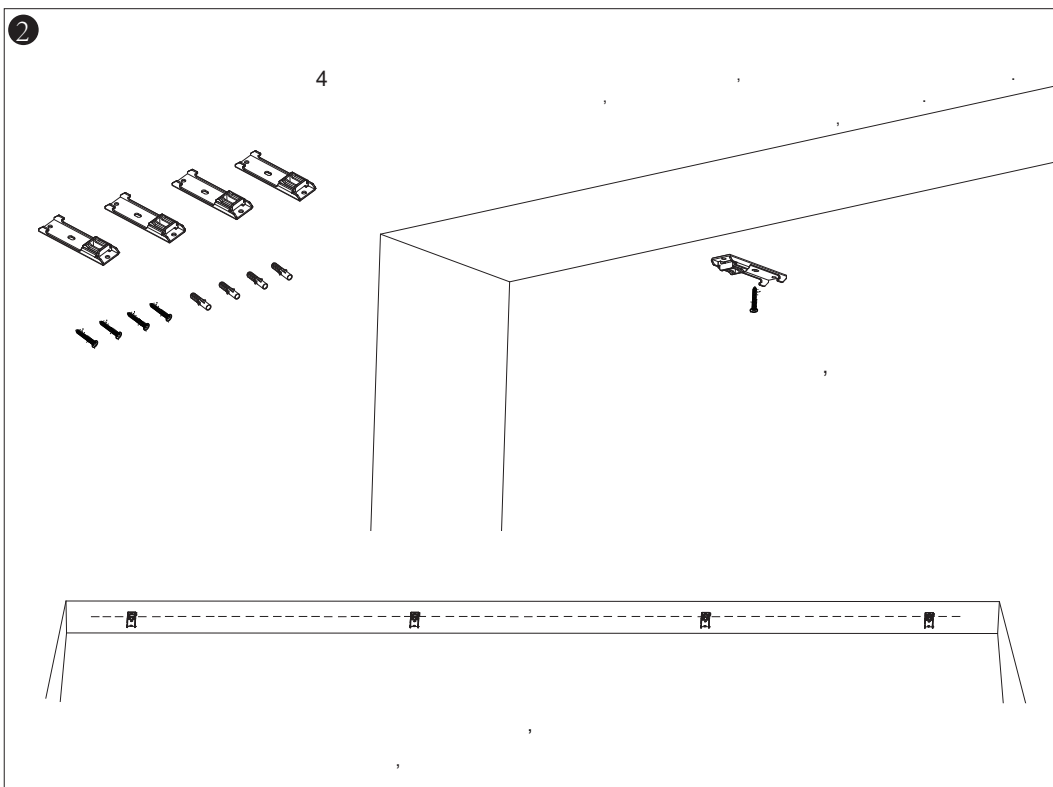

4

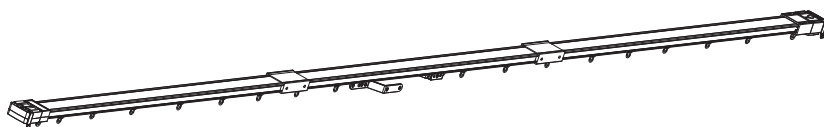
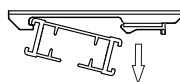
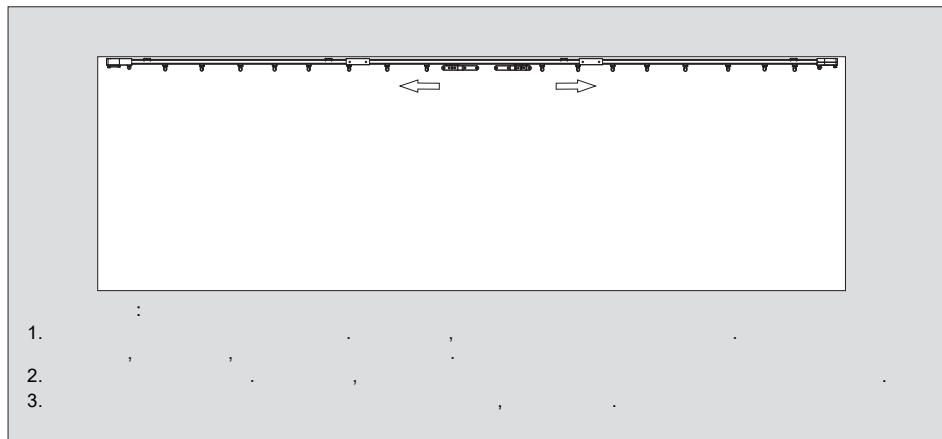

1

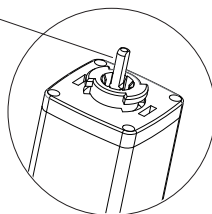
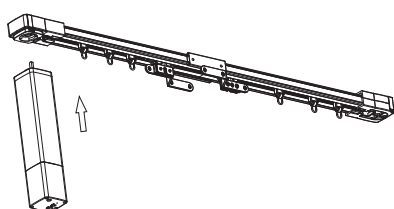
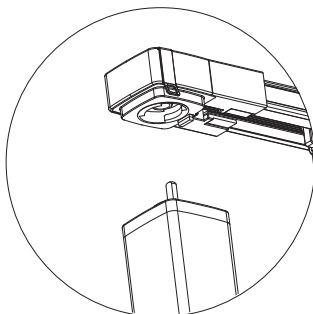
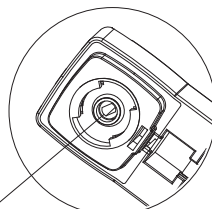
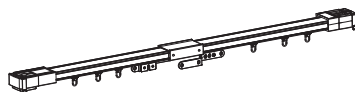
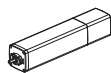

2

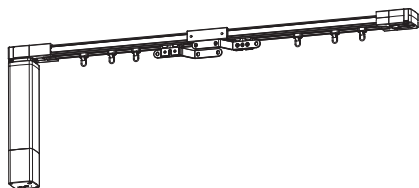

3

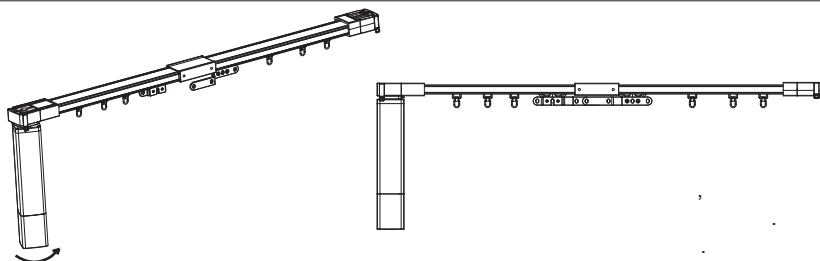

1

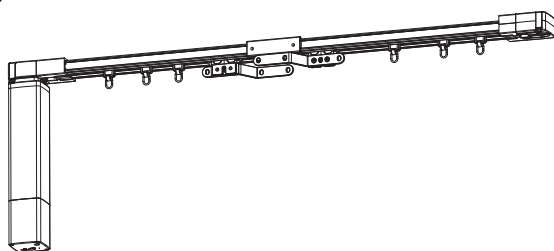

2

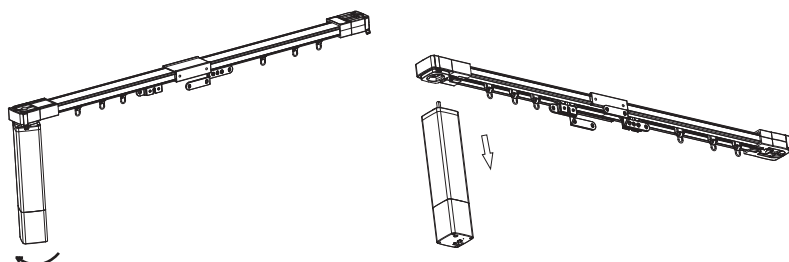

3



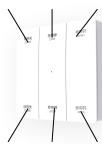

BE602



BE601



BE301

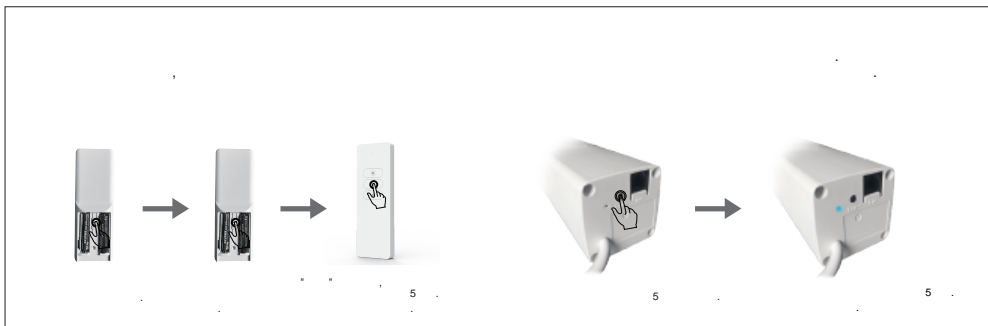
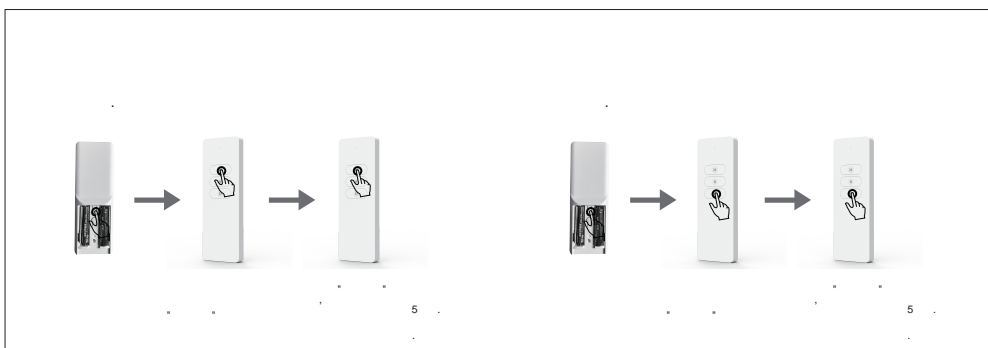
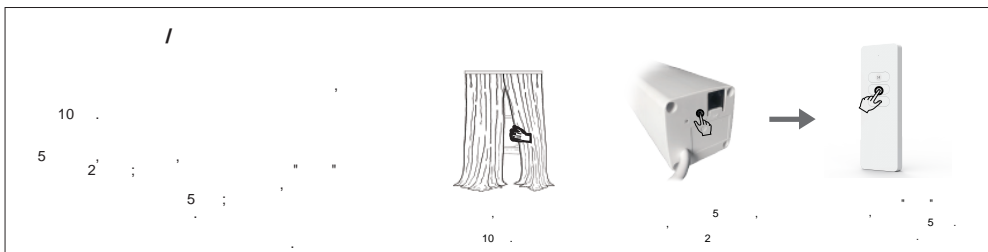
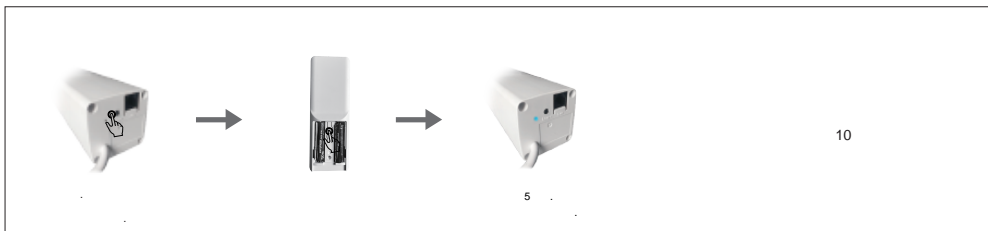
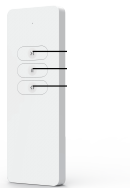



5



4



4



6



6

(

BCM100DE)



5



5



7

1 ( . . ).



7

1.

2.

4

3

# LAN

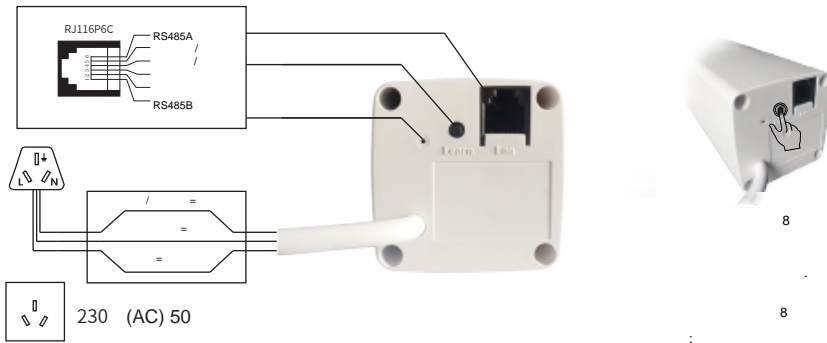

1

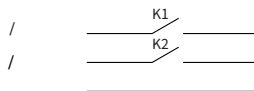

K1 , K2 , ( ) ;  
 K1 , K2 , ;  
 K1 , K2 , ;  
 K1 , K2 , ;  
 K1 , K2 , ( ) ;  
 K1 , K2 , ;  
 K1 , K2 , ;  
 K1 , K2 , .

2

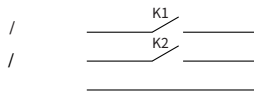

K1 , K2 , ( ) ;  
 K1 , K2 , ;  
 K1 , K2 , ( ) ;  
 K1 , K2 , .

3

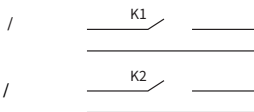

K1 2 ;  
 , K1 , K1 , ( ) ;  
 K1 , , K1 , ;  
 K1 , , K1 , ( ) ;  
 K1 , , K1 ;  
 K1 , K2 , .

4

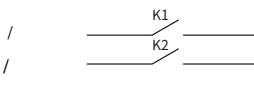

K1 K2 ( ) , ;  
 K1 K2 ( ) , .

### (4 wires)

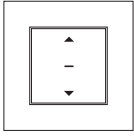

230 (AC) 50

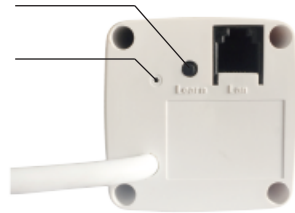
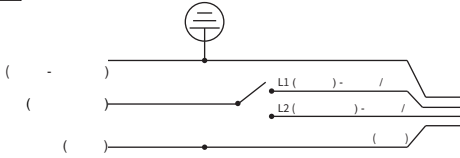

### (5 wires)

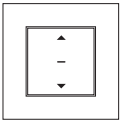

230 (AC) 50

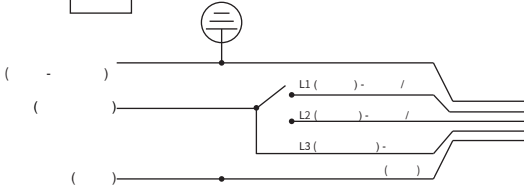

LAN-

