

**SCHUKO® socket, 16 A 250 V ~, thermoplastic lacquered, A range, matt anthracite**

<b>Reference number:</b>	A 1520 BF ANM
<b>EAN/GTIN:</b>	4011377128286
<b>Color:</b>	matt anthracite
<b>Material:</b>	thermoplastic (breakproof)

■ Individual colour printing possible

SCHUKO® socket, A1520BFANM

with screwless terminals for rigid and untreated flexible wires up to 2.5 mm<sup>2</sup>

without claws: ref.-no. with additional "N", e.g.: ..1520 N..

with screw terminals: ref.-no. ..1521..

Supporting frame, claws and claw screws are integrated into the earth protection.

Plastic design cover made from 95% recycled material in accordance with DIN EN ISO 14021 - sustainable, conserves resources

**Accessories:**

Black screws ref.-no.: S-NFB SCHUKO SW

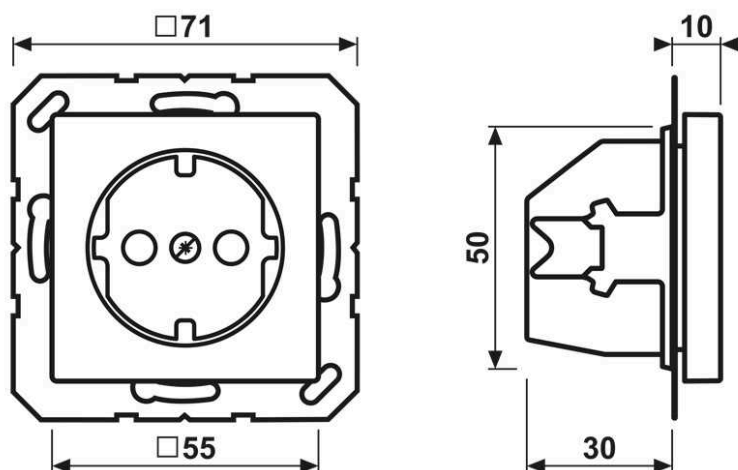
**Dimensions**

## Assembly

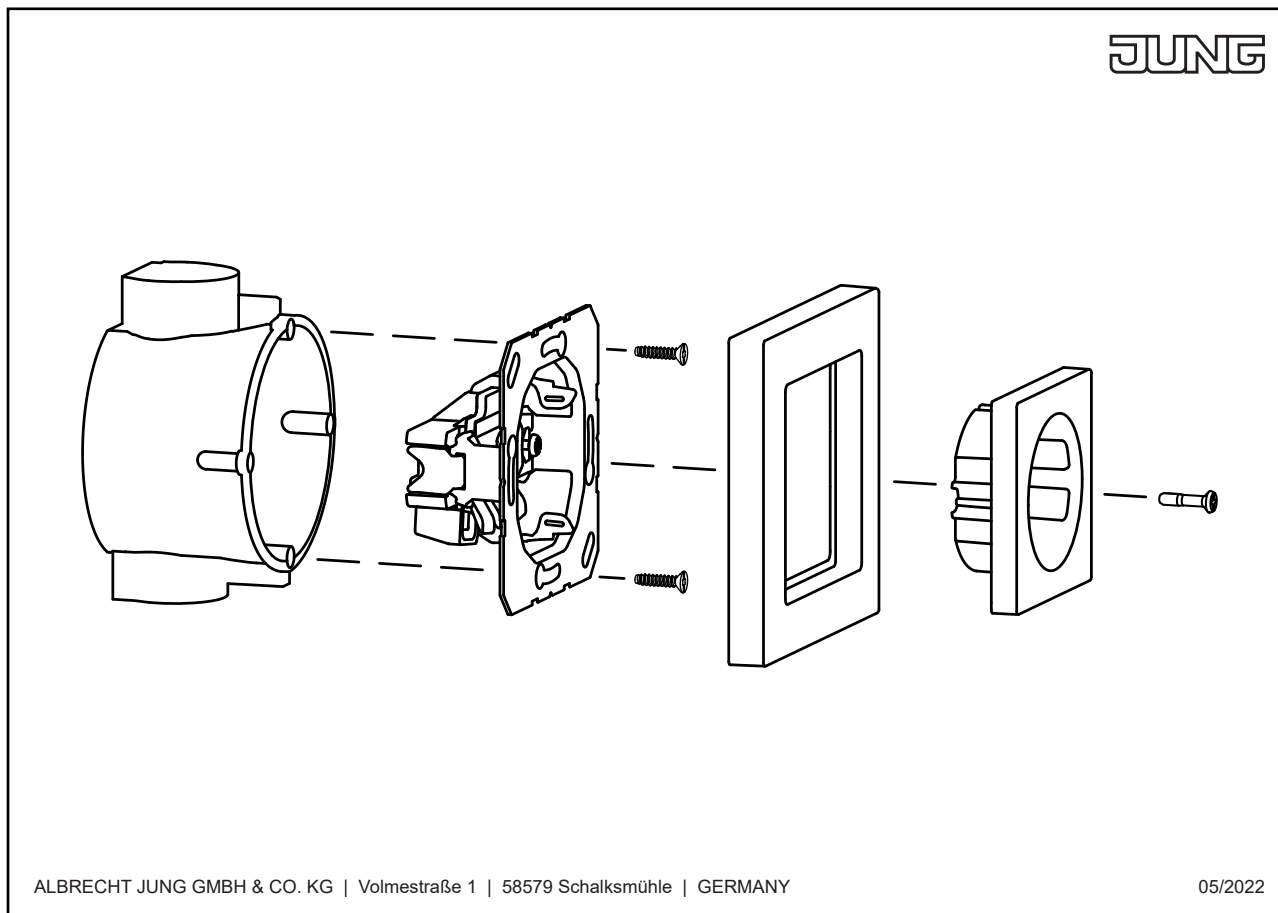

ALBRECHT JUNG GMBH &amp; CO. KG | Volmestraße 1 | 58579 Schalksmühle | GERMANY

05/2022

**Notice!****Installation only by persons with relevant electrical knowledge and experience!\*)****Use only with original JUNG product components approved for this article.**

By inappropriate installation you endanger

- your own life,
- the life of the user of the electrical appliance.

By inappropriate installation you risk a high loss by damage, e.g. risk by fire.

You assume personal liability in case of injury to persons or damage of appliances.

**Please contact a skilled electrician!****\*) Required technical knowledge for installation:**

For installation, especially the following technical knowledge is required:

- the 5 important safety rules: disconnect from mains, secure against reconnecting, verify parts are free of voltage, ground and short-circuit, cover or block off adjacent live parts
- select adequate tools, measuring devices and personal protective equipment
- evaluate measuring results
- selection of the electrical installation material to secure switch-off conditions
- IP protection levels
- installation of the electrical installation material
- type of electric power grid (TN system, IT system, TT system) and the resultant connection terms (common grounding, protective ground, required additional action etc.)